











# Enmore Road £575,000

Enmore, Bridgwater Ref: 33028802

**Bridgwater**

**Telephone:** [01278 258005](tel:01278258005)

**Email:** [office@josephcasson.co.uk](mailto:office@josephcasson.co.uk)

1 Friarn Lawn, Bridgwater, Somerset, TA6 3LL

**Taunton**

**Telephone:** [01823 740051](tel:01823740051)

**Email:** [taunton@josephcasson.co.uk](mailto:taunton@josephcasson.co.uk)

2 The Crescent, Taunton, Somerset, TA1 4EA

image not found or ty

## Gallery







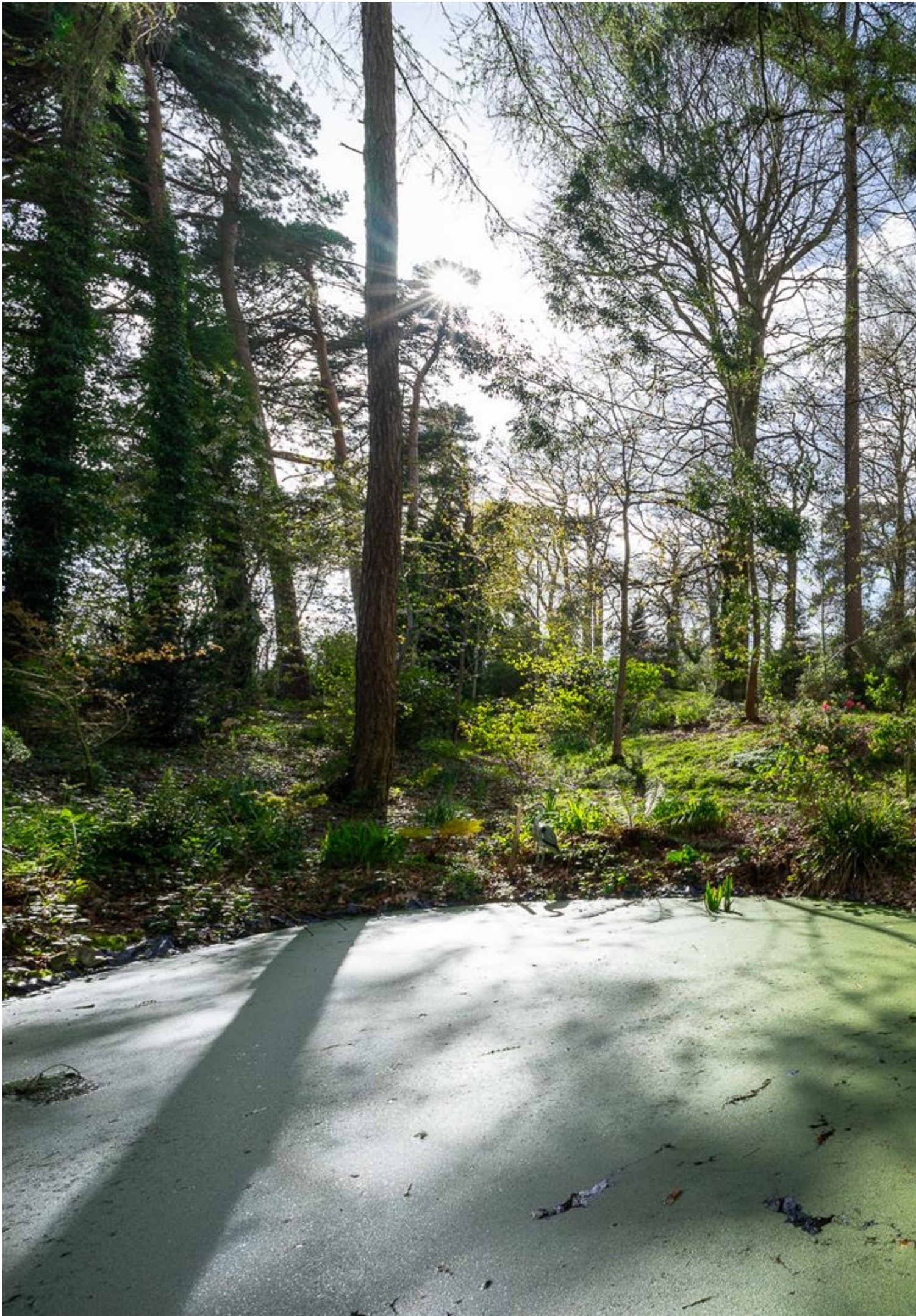







**Bridgwater**

**Taunton**

**Telephone:** [01278 258005](tel:01278258005)

**Telephone:** [01823 740051](tel:01823740051)

**Email:** [office@josephcasson.co.uk](mailto:office@josephcasson.co.uk)

**Email:** [taunton@josephcasson.co.uk](mailto:taunton@josephcasson.co.uk)

1 Friarn Lawn, Bridgwater, Somerset, TA6 3LL 2 The Crescent, Taunton, Somerset, TA1 4EA



## Property Description

**Location:** Enmore, Bridgwater

Nestled on the edge of Enmore, this charming detached cottage boasts a generous amount of space and is surrounded by lush gardens and woodlands spanning over an acre. Enjoy picturesque countryside views from this tranquil location.

**ACCOMMODATION** - Hillandale is a charming stone cottage that has been expanded over time while preserving its original period details like beamed ceilings and a fireplace with a wood-burning stove. The spacious layout includes two reception rooms, a fitted kitchen, a cloakroom, a hallway, and a large conservatory with stunning views of the valley and Quantock Hills. Upstairs, there are four bedrooms, a bathroom, and a separate shower room.

The landscaped gardens feature various areas, including a private garden with seating areas, summerhouse, and vegetable plot. A formal garden with a timber workshop leads to a wooded section with flower borders, patio, and entertainment space. A private driveway offers ample parking in front of the house. Totalling 1.18 acres.

**LOCATION** - The picturesque setting of Hillandale offers a tranquil escape from the hustle and bustle of city life. Perched atop the rolling hills of Enmore, residents can enjoy breathtaking views of the surrounding countryside. The nearby Quantock Hills provide ample opportunities for outdoor activities such as hiking and horseback riding. Enmore itself boasts a charming village atmosphere with a church, two cozy pubs, and a well-regarded primary school. For those in need of more amenities, the market town of Bridgwater is just a short drive away, offering a variety of shops and schools. The bustling county town of Taunton is also within easy reach, providing even more options for shopping and entertainment. With its convenient location and stunning natural surroundings, Hillandale truly offers the best of both worlds.

**SERVICES** - Mains: Water & Electricity

Central Heating: Oil

Drainage: Septic Tank. Not thought to comply with the latest regulations.

Council Tax Band: F

Is the property in a conversation area? Yes, AONB. The woodland is also protected.

**Bridgwater**

**Taunton**

Telephone: [01278 258005](tel:01278258005)

Telephone: [01823 740051](tel:01823740051)

Email: [office@josephcasson.co.uk](mailto:office@josephcasson.co.uk)

Email: [taunton@josephcasson.co.uk](mailto:taunton@josephcasson.co.uk)

1 Friarn Lawn, Bridgwater, Somerset, TA6 3LL 2 The Crescent, Taunton, Somerset, TA1 4EA



## Additional Info

For Sale

Beds: 4

Baths: 1

Type: House

Floor Area : 1760 sqft

Detached Cottage Set In A Rural Location

Gardens (and Woodland)

Four Bedrooms

First Floor Bathroom & Shower

Two Reception Rooms & Conservatory

Fitted Kitchen & Cloakroom

Views Of Surrounding Countryside

Ample Parking

EPC RATING: TBC

Council Tax Band: F

Character Features

Country Living

**Bridgwater**

**Taunton**

Telephone: [01278 258005](tel:01278258005)

Telephone: [01823 740051](tel:01823740051)

Email: [office@josephcasson.co.uk](mailto:office@josephcasson.co.uk)

Email: [taunton@josephcasson.co.uk](mailto:taunton@josephcasson.co.uk)

1 Friarn Lawn, Bridgwater, Somerset, TA6 3LL 2 The Crescent, Taunton, Somerset, TA1 4EA



## FloorPlans







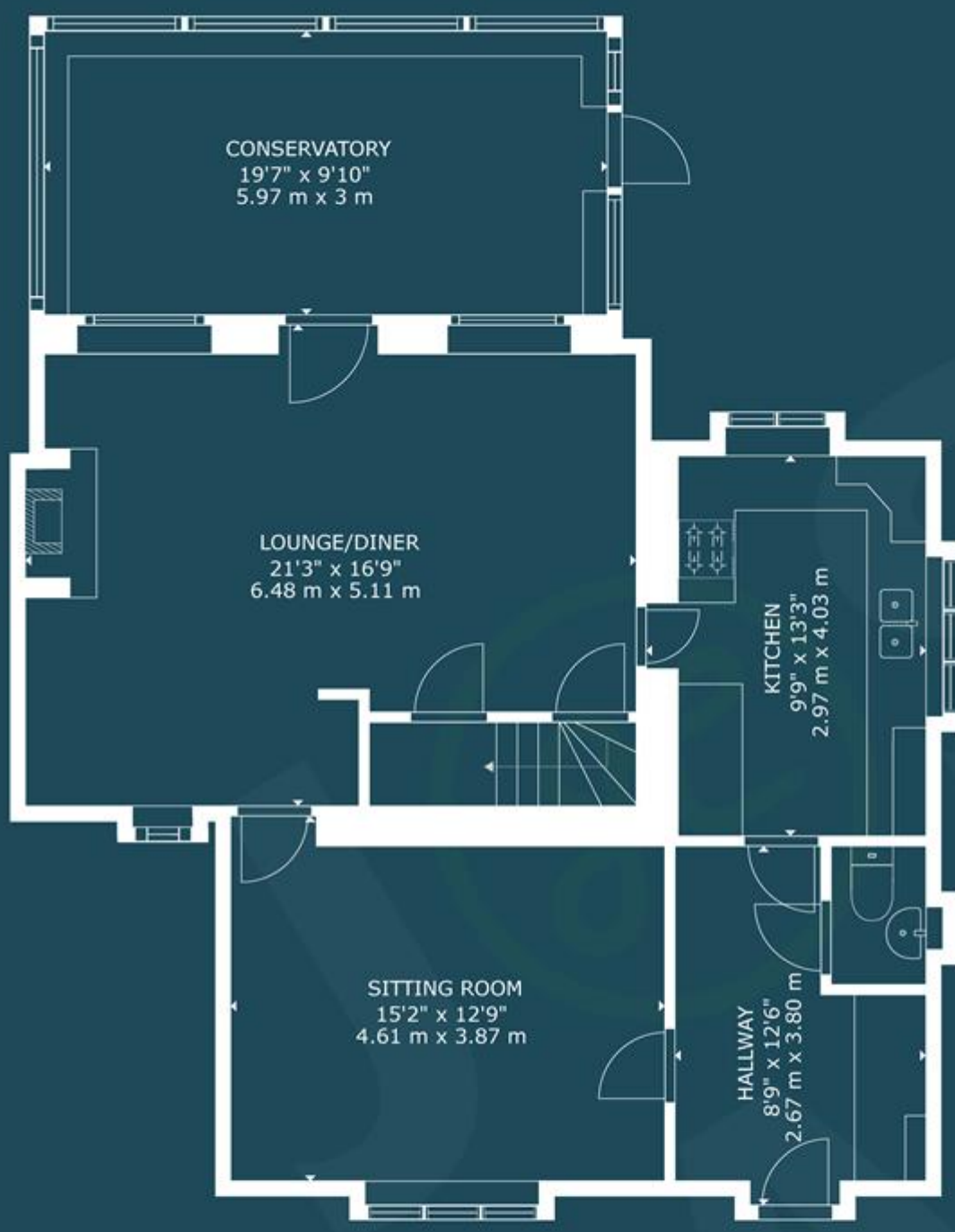

CONSERVATORY  
19'7" x 9'10"  
5.97 m x 3 m

LOUNGE/DINER  
21'3" x 16'9"  
6.48 m x 5.11 m

KITCHEN  
9'9" x 13'3"  
2.97 m x 4.03 m

SITTING ROOM  
15'2" x 12'9"  
4.61 m x 3.87 m

HALLWAY  
8'9" x 12'6"  
2.67 m x 3.80 m

FLOOR 1

GROSS INTERNAL FLOOR AREA  
FLOOR 1: 989 sq ft, 91.89 m<sup>2</sup>, FLOOR 2: 1771 sq ft, 163.77 m<sup>2</sup>  
TOTAL: 1760 sq ft, 162.66 m<sup>2</sup>  
SIZES AND DIMENSIONS ARE APPROXIMATE

## **Bridgwater**

**Telephone:** [01278 258005](tel:01278258005)

**Email:** [office@josephcasson.co.uk](mailto:office@josephcasson.co.uk)

1 Friarn Lawn, Bridgwater, Somerset, TA6 3LL

## **Taunton**

**Telephone:** [01823 740051](tel:01823740051)

**Email:** [taunton@josephcasson.co.uk](mailto:taunton@josephcasson.co.uk)

2 The Crescent, Taunton, Somerset, TA1 4EA

