











**High Street**      **£275,000**

**Stogursey, Bridgwater** Ref: 33187465

**Bridgwater**

**Taunton**

**Telephone:** [01278 258005](tel:01278258005)

**Telephone:** [01823 740051](tel:01823740051)

**Email:** [office@josephcasson.co.uk](mailto:office@josephcasson.co.uk)

**Email:** [taunton@josephcasson.co.uk](mailto:taunton@josephcasson.co.uk)

1 Friarn Lawn, Bridgwater, Somerset, TA6 3LL    2 The Crescent, Taunton, Somerset, TA1 4EA

 image not found or type

## Gallery















**Bridgwater**

**Taunton**

**Telephone:** [01278 258005](tel:01278258005)

**Telephone:** [01823 740051](tel:01823740051)

**Email:** [office@josephcasson.co.uk](mailto:office@josephcasson.co.uk)

**Email:** [taunton@josephcasson.co.uk](mailto:taunton@josephcasson.co.uk)

1 Friarn Lawn, Bridgwater, Somerset, TA6 3LL 2 The Crescent, Taunton, Somerset, TA1 4EA



## Property Description

**Location:** Stogursey, Bridgwater

This charming cottage is bursting with character and original features, such as exposed beams and stone walls, adding to its unique appeal. With its convenient location and delightful surroundings, this property offers the perfect blend of rural charm and modern convenience. Don't miss the opportunity to make this enchanting cottage your new home. Contact us today to arrange a viewing and discover all that this wonderful property has to offer.

**ACCOMMODATION** - Believed to date back to the 16th century, this impressive village property benefits from oil central heating and briefly comprises: a lounge with a wood burner, an open-plan kitchen/diner, a bedroom (3), and a shower room to the ground floor. Arranged on the first floor and accessed from the split landing are two double bedrooms and a bathroom. Outside, there is parking to the front aspect and a garage. To the rear is a beautifully maintained garden of generous proportions.

NB. Please be advised that five new build properties are being constructed on the land to the side of the property. Somerset Council planning application number 3/32/21/007.

**LOCATION** - Stogursey is a pretty village in north-west Somerset, 3 miles from the A39, 9 miles from Bridgwater and between the Quantock Hills and the sea. It has a thriving community, and good amenities including an attractive church, a castle with moat, post office, shops, primary school, village hall and a pub. Hinkley point is also easily accessible by the circular HPC bus or by car.

**Bridgwater**

**Taunton**

**Telephone:** [01278 258005](tel:01278258005)

**Telephone:** [01823 740051](tel:01823740051)

**Email:** [office@josephcasson.co.uk](mailto:office@josephcasson.co.uk)

**Email:** [taunton@josephcasson.co.uk](mailto:taunton@josephcasson.co.uk)

1 Friarn Lawn, Bridgwater, Somerset, TA6 3LL 2 The Crescent, Taunton, Somerset, TA1 4EA



## Additional Info

For Sale  
Type: House  
Two First Floor Bedrooms  
Lounge with Wood Burner  
Garage & Driveway

Beds: 3  
Floor Area : 1414 sqft  
One Ground Floor Bedroom  
Kitchen/Diner  
Enclosed Rear Garden

Baths: 2  
Semi-Detached Character Property  
Two Bathrooms  
Oil Central Heating  
EPC Rating: TBC

## Open-Plan Kitchens

### **Bridgwater**

**Telephone:** [01278 258005](tel:01278258005)

**Email:** [office@josephcasson.co.uk](mailto:office@josephcasson.co.uk)

1 Friarn Lawn, Bridgwater, Somerset, TA6 3LL

### **Taunton**

**Telephone:** [01823 740051](tel:01823740051)

**Email:** [taunton@josephcasson.co.uk](mailto:taunton@josephcasson.co.uk)

2 The Crescent, Taunton, Somerset, TA1 4EA



Image not found or ty

## **FloorPlans**







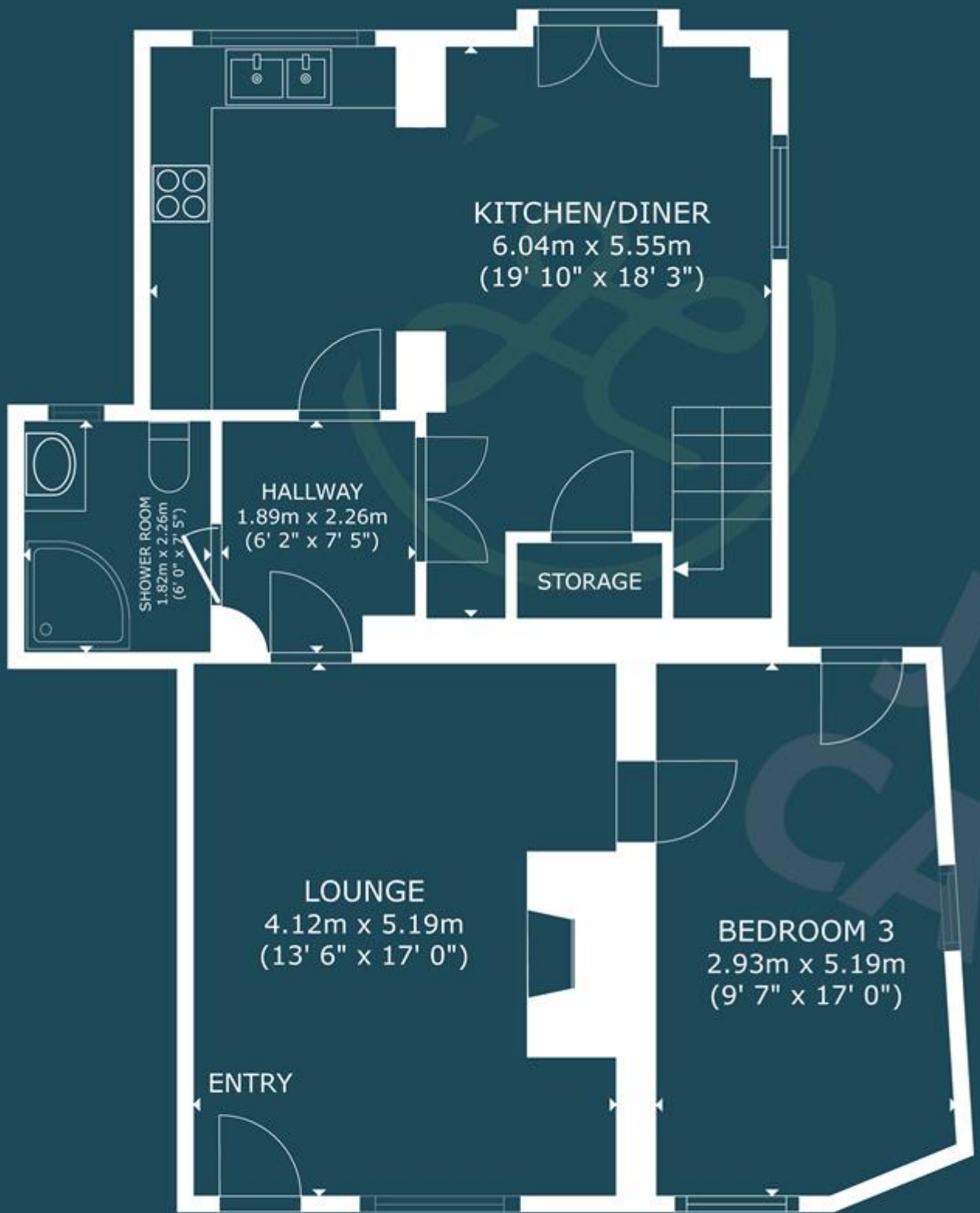

## FLOOR 1

GROSS INTERNAL AREA  
 FLOOR 1 76.7 m<sup>2</sup> (826 sq.ft.) FLOOR 2 5  
 EXCLUDED AREAS : REDUCED HEADROOM  
 TOTAL : 131.4 m<sup>2</sup> (1,414 sq.ft.)

SIZES AND DIMENSIONS ARE APPROXIMATE, AND

## **Bridgwater**

**Telephone:** [01278 258005](tel:01278258005)

**Email:** [office@josephcasson.co.uk](mailto:office@josephcasson.co.uk)

1 Friarn Lawn, Bridgwater, Somerset, TA6 3LL

## **Taunton**

**Telephone:** [01823 740051](tel:01823740051)

**Email:** [taunton@josephcasson.co.uk](mailto:taunton@josephcasson.co.uk)

2 The Crescent, Taunton, Somerset, TA1 4EA



Image not found or ty